



S - T - R

ST RESOURCES THAILAND CO., LTD

No. 9 The place Building, 2nd fl., Unit 2201, Chan Road 18/2,
Thung Wat Don, Sathorn, Bangkok 10120

Website: <https://stresourcesthailand.com>

E- Mail: sales@stresourcesthailand.com

Sales support department (Petro equipment)

Contact: Mr. Povitha

STR FIRE FIGHTING VALVE



CAST IRON GLOBE VALVE



DESCRIPTION OF PRODUCT

The globe valve for water has a rising rotating stem and handwheel. The cast iron globe valve is used often in applications like Heating, water distribution and water at Min and max Temperatures between -10°C to $+120^{\circ}\text{C}$. Cast iron globe valves of this type are available for use in commercial and industrial applications.

THE WORKING PRINCIPLE

Cast Iron Globe valve can be used to regulate the opening and closing linearly from 0 to 100% or fully open. Used for installation and use in environments: superheated steam, saturated steam, liquid gas, vacuum, frozen environment. The handwheel controls the valve shaft to rotate around the valve body, pulling the valve disc up and down, and the valve opens and closes.

The water flow through the valve will swirl upwards, so the pressure of the back flow through the valve will be consumed and cause a pressure drop. With the same structure and operating mechanism as on the globe valve, it has the ability to throttle the flow better than the gate valve. In addition, they are less likely to leak than other industrial valves.

TECHNICAL SPECIFICATION :

Size : DN15-DN300

Body : Cast Iron

Connection Type : Flange, Welded, Threaded

Working pressure : PN10/16/25/40/63

Temperature : $-10^{\circ}\text{C} \sim 400^{\circ}\text{C}$

Flange standard : JIS, DIN , ANSI, BS

Operation Type : Hand crank , electric control , pneumatic control

Operating medium : Water , compressed air , hot steam , hot oil , chemicals

Origin : Korea , Taiwan , China , EU

THE DETAILED DRAWING

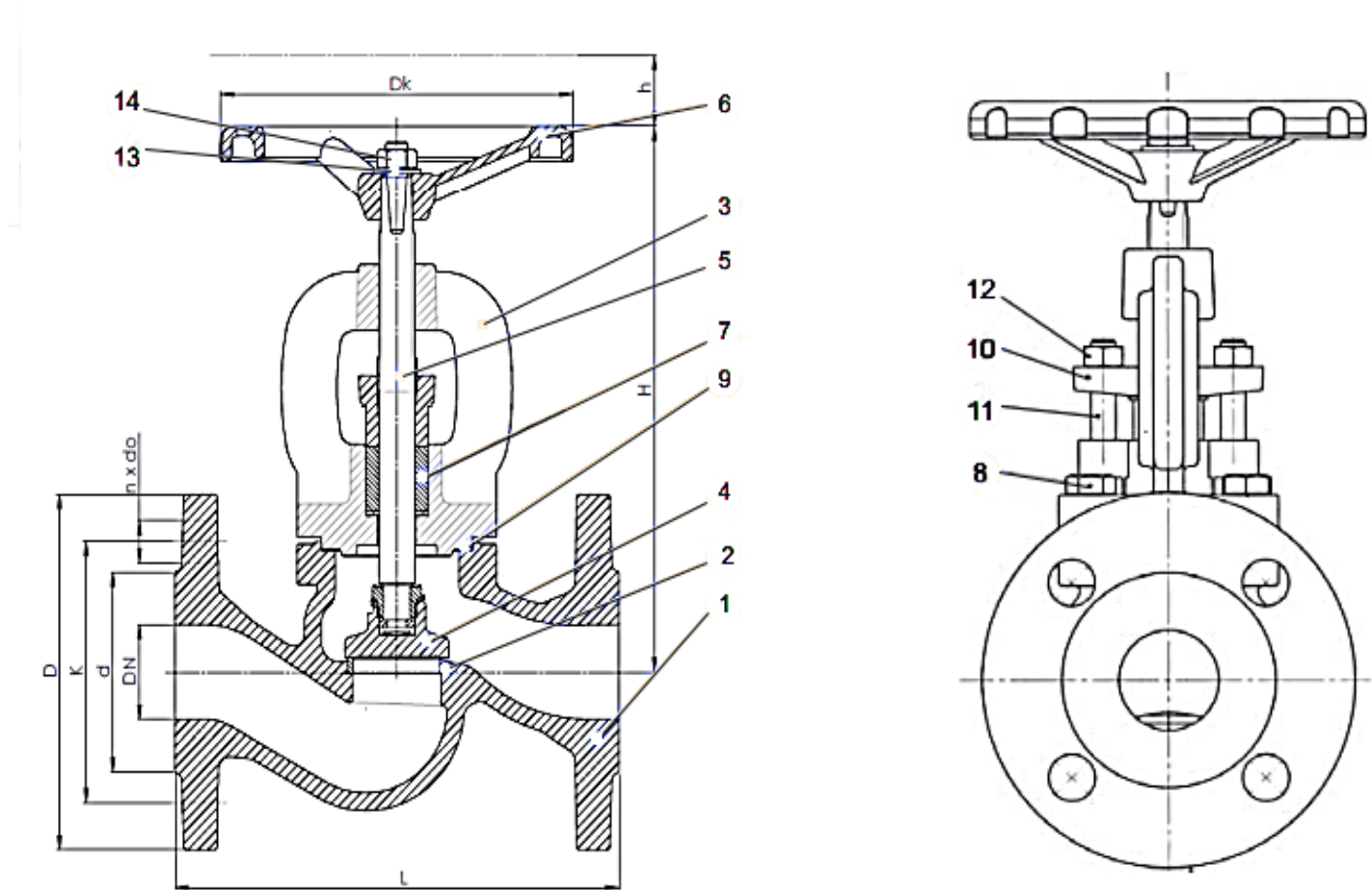

DIMENSION

Size	D	d	K	nxd	Dk	h	L	H
2"	165	99	125	4x14	160	25	230	248
3"	200	132	160	8x19	200	41	310	291
4"	220	156	180	8x19	250	31	350	338
6"	285	211	240	8x23	320	54	480	429
8"	340	266	295	12x23	360	77	600	529
10"	405	319	355	12x28	360	120	730	638

NUMNERS AND PARTNAMES

Part names	No.	Material
Body	1	EN GJL 250 Cast Iron
Seat ring	2	X12Cr13
Bonnet	3	EN GJL 250 Cast Iron
Disc	4	X20Cr13
Stem	5	X20Cr13
Hand Wheel	6	EN GJL 500–7 Cast Iron
Gland packed	7	Graphite
Hexagon bolt	8	8.8 Steel
Gasket	9	Graphite & NiCr
Gland	10	EN GJL 2250 Cast Iron
T Bolt	11	Zinc Galvanized 5.8 Steel
Nut	12	Zinc Galvanized 8 Steel
Whasher	13	Zinc Galvanized Carbon Steel
Nut	14	Zinc Galvanized 8 Steel

