



ST RESOURCES THAILAND CO., LTD

No. 9 The place Building, 2nd fl., Unit 2201, Chan Road 18/2,
Thung Wat Don, Sathorn, Bangkok 10120

Website: <https://stresourcesthailand.com>

E- Mail: sales@stresourcesthailand.com

Sales support department

Contact: Mr.Phovitha



EMERGNCY PRESSURE RELIEF VENT

MODEL: TEPV



THE DESCRIPTION OF PRODUCT

The model TEPV - is the typical emergency valve required by API standard 2000 for the emergency flow charge because of the exposure of a tank of flame. The model TEPV is designed and installed on storage tanks to protect the tank against excessive pressure caused by external fire exposure. The excessive pressure caused by an external fire is generally because an adjacent tank is on fire or some other structure in close proximity is on fire. Regardless of the cause of the excessive pressure, an opening larger than the normal pressure valve is necessary in order to carry off the additional volume resulting from the fire exposure the tank is experiencing.

THE WORKING PRINCIPLE

When internal pressure in the tank goes up, due to product filling or vapor development, the set pressure will be increased, accordingly, the pressure disc will be opened and discharge the gas to atmosphere. The set pressure can be arranged according to storage tank requirements and the breather valve will be reset when internal pressure returns to below set pressure. The vacuum disc is similarly maintained in the closed position. When excessive pressure builds within the storage tank, the emergency pressure valve hinged cover begins to open at the predetermined set pressure, relieving excess pressure. When the overpressure has dissipated the cover reseats onto the base. The hinge mechanism prevents misalignment and provides an accurate reseal.

KEY CONSTRUCTION AND MODELS

Standard size	:Inch 16" -18" - 20" - 24"	DN: DN400 - DN450 - DN500 - DN600
Models	:TEPVC (WCB - Cast steel)	TEPVS (Stainless steel)
Set pressure	:Range 40mmW.C to 700mmW.C for weight loaded valves	
End connecion	:Flange according to ANSI150FF/150RF, JIS - 10K, DIN, ...	
Paint	:Grey epoxy on request	

THE DETAILED DRAWING AND DIMENSION PARTNAMES

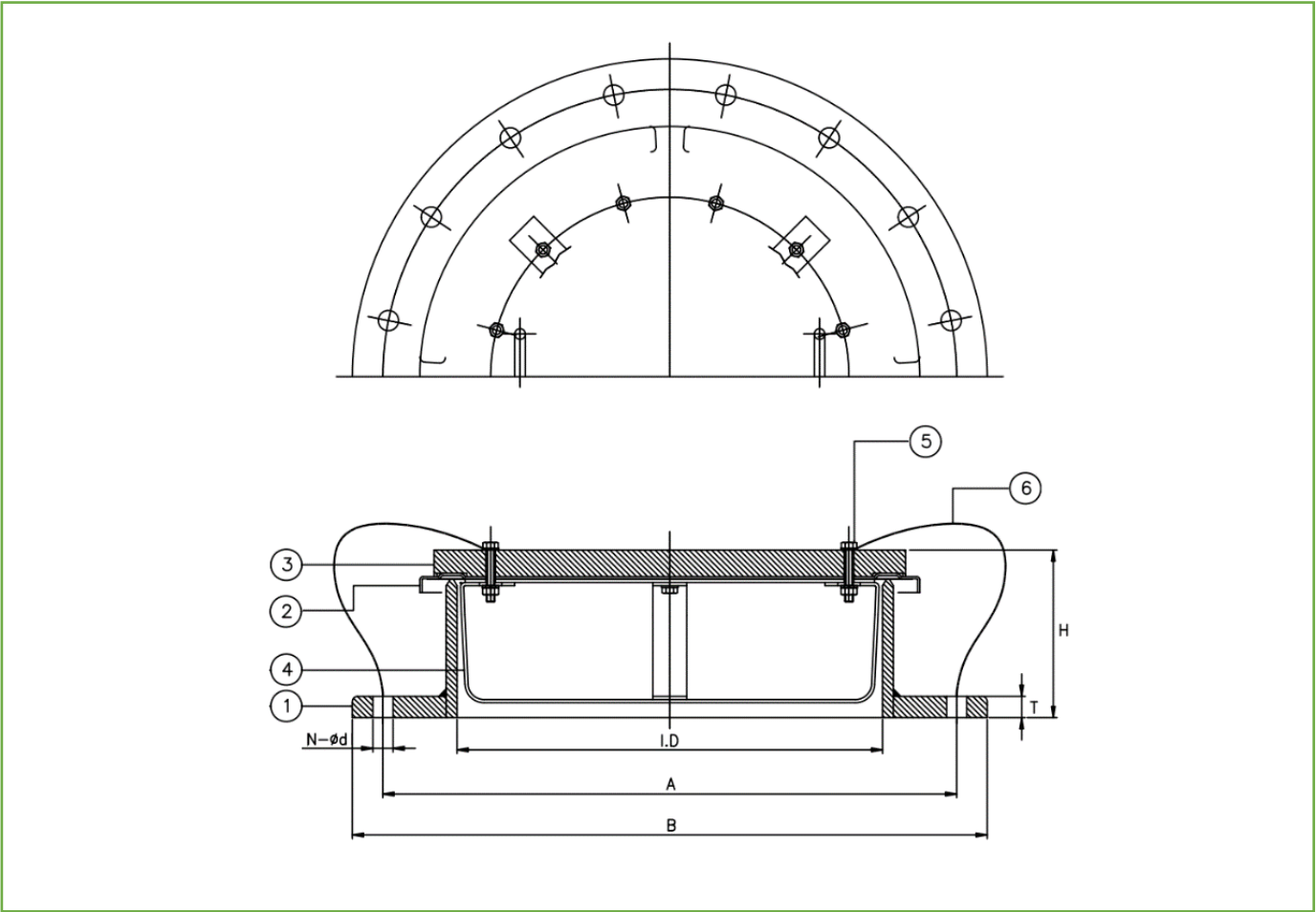

DIMENSIONS

Size	16"	18"	20"	24"
I. D	400	450	500	600
A	540	610	598	698
B	598	636	660	764
T	20	20	20	20
H	155	165	180	200

Notes: UOM: mm, Dimensions (A,B,C,H) can be the allowable tolerance

NUMNERS AND PARTNAMES

Part names	No.	WCB	SS304	SS316
Body	1	A216-WCB	CF8	SS316
Cover/disc/ diaphragm	2	SS304/SS304/PTFE		SS316/PTFE
Loading weight	3	ASTM A283	SS304	SS316
Guide	4	ASTM A240	SS304	SS316
Bolt/nut/washer	5	SS304		SS316
Earth cable wire	6	SS304		SS316

