



ST RESOURCES THAILAND CO., LTD

No. 9 The place Building, 2nd fl., Unit 2201, Chan Road 18/2,
Thung Wat Don, Sathorn, Bangkok 10120

Website: <https://stresourcesthailand.com>

E- Mail: sales@stresourcesthailand.com

Sales support department (Petro equipment)

Contact: Mr. Povitha



HORIZONTAL CENTRIFUGAL PUMP

MODEL: TNP WITH EN 733 STANDARD



DECRPTION OF PRODUCT

Model TSP according to EN733 - Self-priming pumps have a unique design that includes a built-in mechanism or feature to evacuate air from the pump casing and suction line, allowing the pump to create a vacuum and draw in the fluid to be pumped. This makes them particularly useful in situations where the pump is located above the fluid source or where the fluid supply may be intermittent or contain air pockets.

The TSP is a type of centrifugal pump designed to automatically remove gas or air from the suction side of the pump during the priming process. This is traditional centrifugal pumps, the pump casing and impeller must be filled with liquid (primed) before the pump can start pumping effectively. However, self-priming pumps are specifically engineered to overcome this limitation

STANDARD DESIGN

The model TSP - self-priming pump is based on DIN24256 international standards, the centrifugal pump and self-priming centrifugal pump performance combined, self-designed and developed strong self-priming industrial pump.

MAIN USAGE

Widely used in various industries and applications included fuel transfer, chemical, energy plants, mining, firefighting, irrigation, water supply, water treatment, dewatering, and marine,...

MODEL PUMP

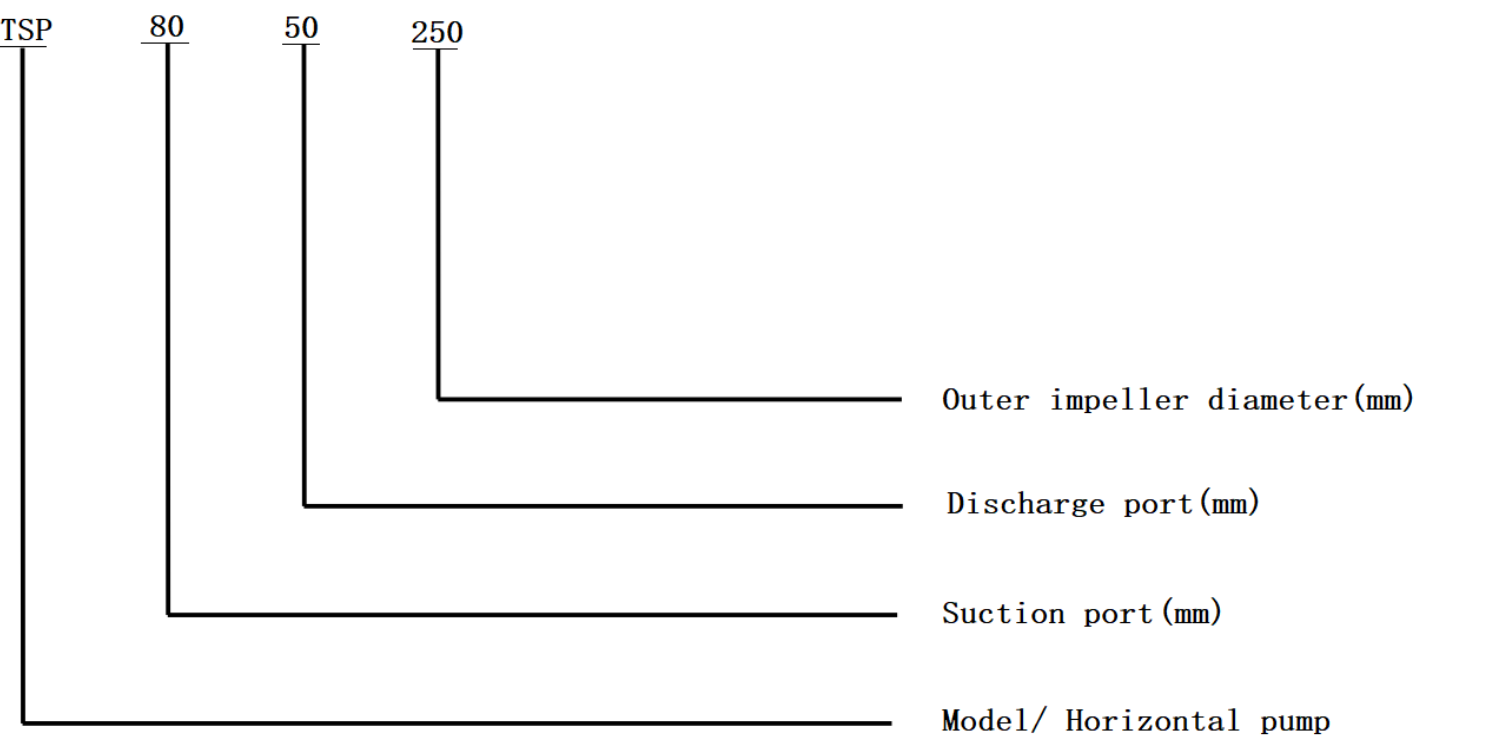

DRAWING PUMP

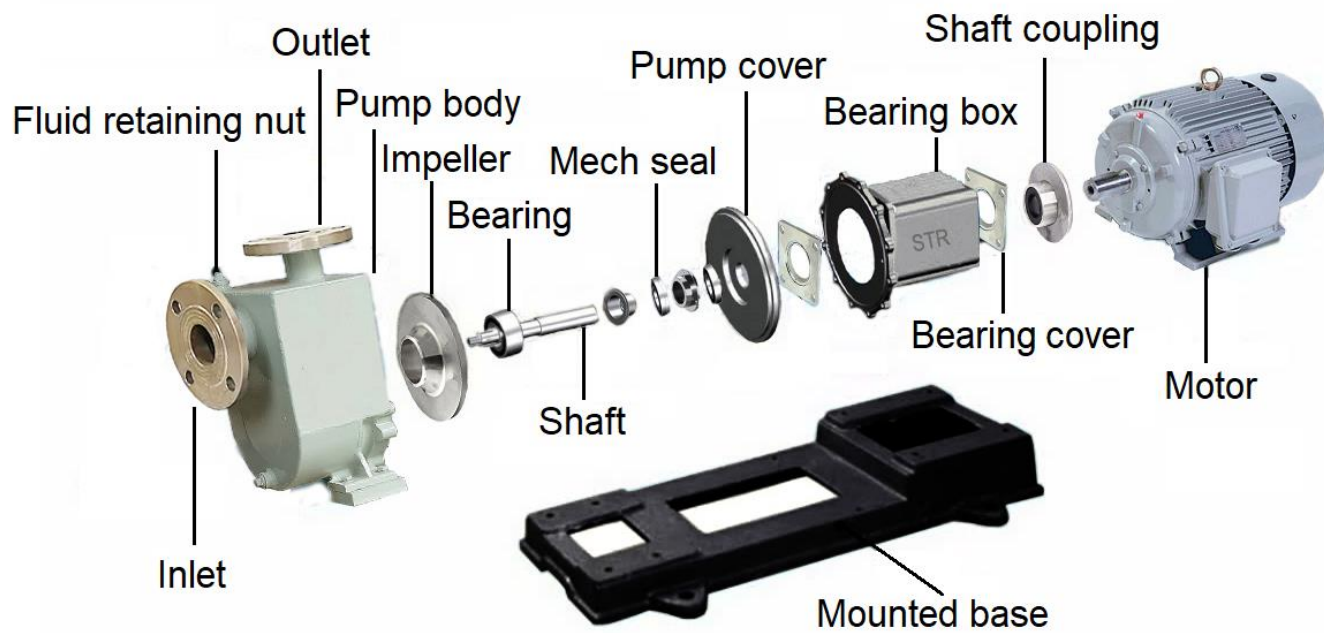
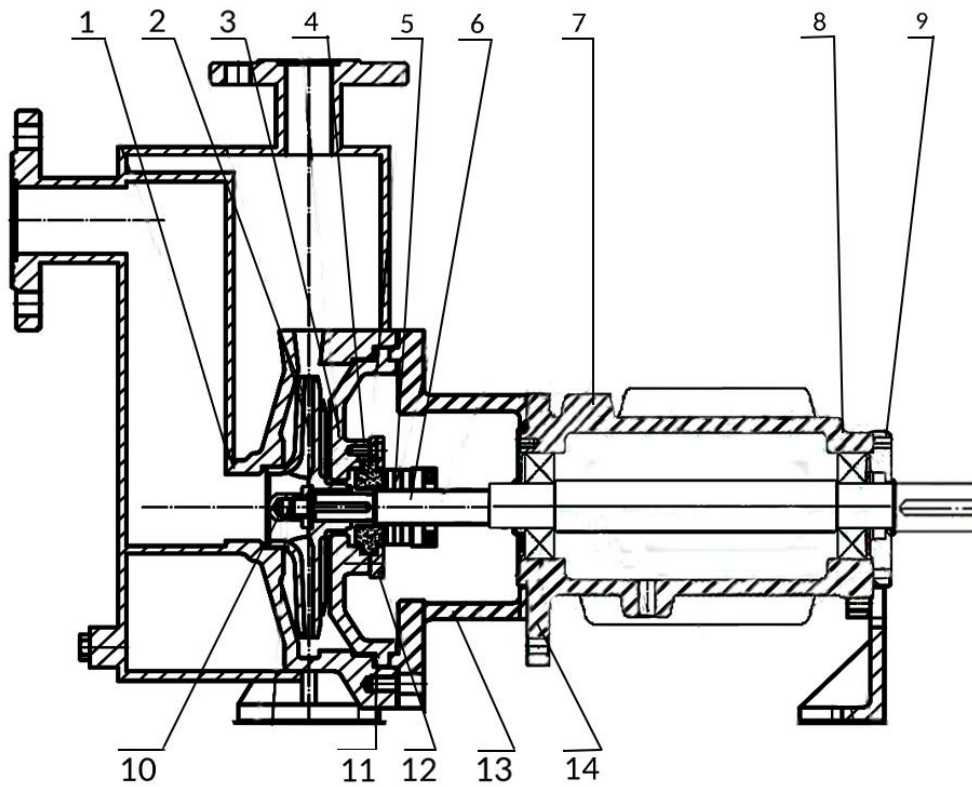

PART NUMBER AND PART NAME

Name	No.	Material	Name	No.	Material
Thrust washer	1	PTFE/Viton	Front bearing	8	NSK(or equivalent)
Impeller	2	SS304/SS316/SS316L	Rear bearing cover	9	HT200
Pump cover	3	WCB/stainless steel	Impeller nut	10	SS304/SS316/SS316L
Static ring	4	Sic/Cemented car	Seal ring	11	PTFE/Viton
Dymaic ring	5	Sic/Cemented car	Static ring cover	12	SS304/SS316/SS316L
Shaft	6	SS420/SS304/SS316	Supporting foot	13	HT200
Front bearing	7	NSK(or equivalent)	From bearing cover	14	HT200

PERFORMANCE CURVE

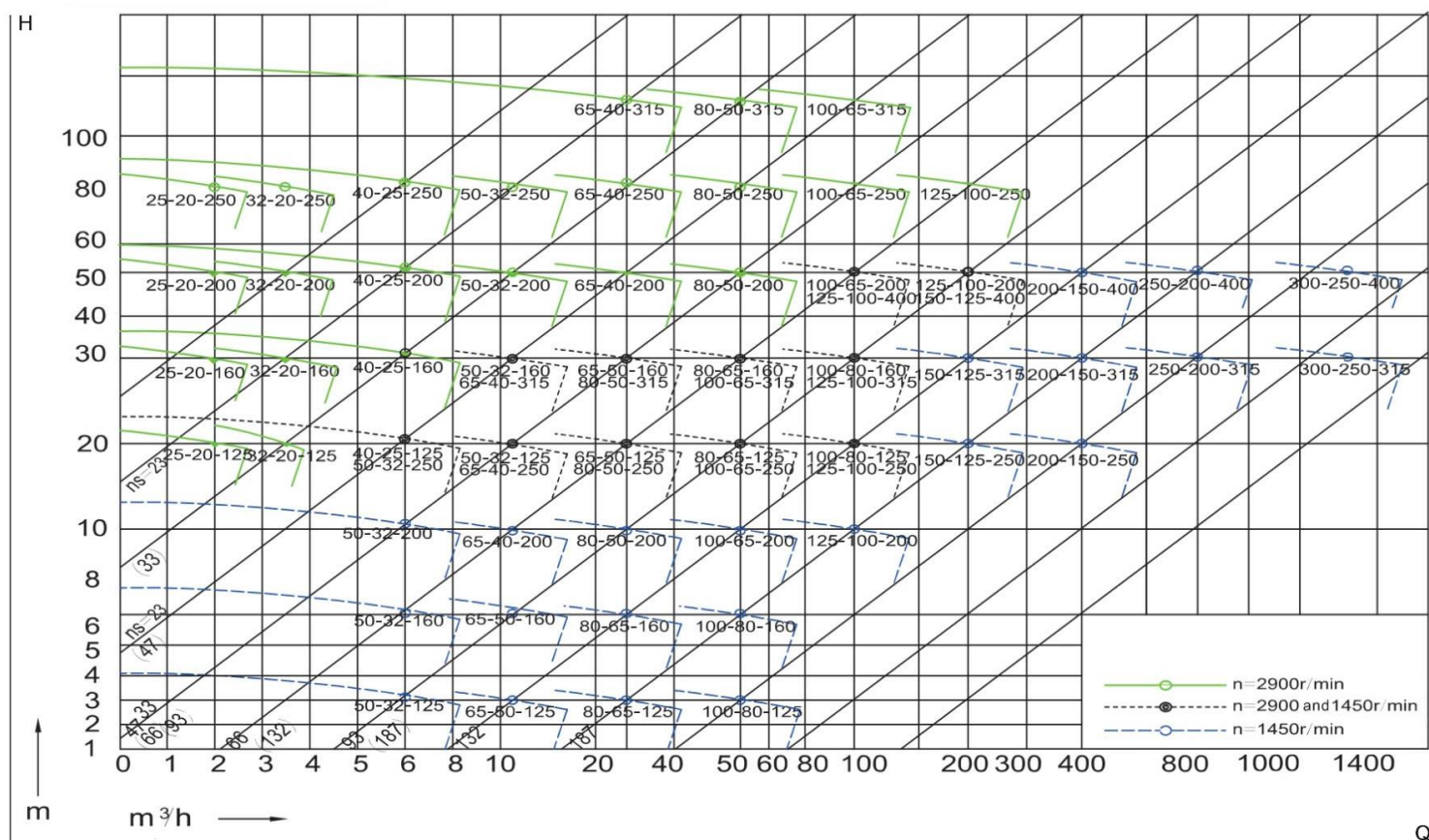

Notes: Performance curve will be provided with each offer and included the requested model for clients

MODEL SELECTION

No.	Model	Flow	Head	EFF	Self priming height	Suction	Discharge	Speed	Motor power	Weight
		m3/h	m	%	m	mm	mm	r/mim	kw	kg
1	25-20-125	2	20	36	0 ~ 3	25	20	2900	1.5	80
2	25-20-160	2	32	32	0 ~ 3	25	20	2900	2.2	85
3	25-20-200	2	50	32	0 ~ 3	25	20	2900	5.5	130
4	25-20-250	2	80	30	0 ~ 3	25	20	2900	11	230
5	32-20-125	3.2	20	44	0 ~ 3	32	20	2900	1.5	80
6	32-20-160	3.2	32	44	0 ~ 3	32	20	2900	2.2	103
7	32-20-200	3.2	50	36	0 ~ 3	32	20	2900	5.5	145
8	32-20-250	3.2	80	30	0 ~ 3	32	20	2900	11	165
9	40-25-125	6.3	20	46	0 ~ 3	40	25	2900	1.5	80
10	40-25-160	6.3	32	40	0 ~ 3	40	25	2900	2.2	130
11	40-25-200	6.3	50	33	0 ~ 3	40	25	2900	5.5	172
12	40-25-250	6.3	80	28	0 ~ 3	40	25	2900	11	258
13	50-32-125	12.5	20	51	0 ~ 3	50	32	2900	2.2	115
14	50-32-160	12.5	32	46	0 ~ 3	50	32	2900	3	138
15	50-32-200	12.5	50	39	0 ~ 3	50	32	2900	5.5	182
16	50-32-250	12.5	80	33	0 ~ 3	50	32	2900	11	258
17	65-50-125	25	20	62	0 ~ 3	65	50	2900	3	138
18	65-50-160	25	32	57	0 ~ 3	65	50	2900	5.5	158
19	65-40-200	25	50	52	0 ~ 3	65	40	2900	11	215
20	65-40-250	25	80	46	0 ~ 3	65	40	2900	15	362
21	65-40-315	25	125	39	0 ~ 3	65	40	2900	30	485
22	80-65-125	50	20	63	0 ~ 3	80	65	2900	4	198
23	80-65-160	50	32	67	0 ~ 3	80	65	2900	7.5	230
24	80-50-200	50	50	63	0 ~ 3	80	50	2900	11	255
25	80-50-250	50	80	57	0 ~ 3	80	50	2900	22	485
26	80-50-315	50	125	51	0 ~ 3	80	50	2900	37	565
27	100-80-125	100	20	73	0 ~ 3	100	80	2900	11	250
28	100-80-160	100	32	73	0 ~ 3	100	80	2900	15	255
29	100-65-200	100	50	72	0 ~ 3	100	65	2900	22	485



SS impeller



SS shaft sleeve



SS shaft



Mechanical seal

No.	Model	Flow	Head	EFF	Self priming height	Suction	Discharge	Speed	Motor power	Weight
		m3/h	m	%	m	mm	mm	r/min	kw	kg
30	100-65-250	100	80	68	0 ~ 3	100	65	2900	37	555
31	100-65-315	100	125	62	0 ~ 3	100	65	2900	75	675
32	125-100-200	200	50	77	0 ~ 3	125	100	2900	45	665
33	125-100-250	200	80	75	0 ~ 3	125	100	2900	75	855
34	125-100-250	100	20	72	0 ~ 3	125	100	1450	11	663
35	125-100-315	100	32	68	0 ~ 3	125	100	1450	15	955
36	125-100-400	100	50	62	0 ~ 3	125	100	1450	30	1060
37	150-125-250	200	20	77	0 ~ 3	150	125	1450	18.5	640
38	150-125-315	200	32	75	0 ~ 3	150	125	1450	30	710
39	150-125-400	200	50	70	0 ~ 3	150	125	1450	45	1250
40	200-150-250	400	20	79	0 ~ 3	200	150	1450	37	720
41	200-150-315	400	32	79	0 ~ 3	200	150	1450	45	1200
42	200-150-400	400	50	78	0 ~ 3	200	150	1450	75	1450

Note: The above are rated parameters, the actual operating parameters and rated parameters are different, it can be replace the impeller to meet the requirements.



Mechanical seals with materials: Stainless steel, Special alloys, Graphite, Ceramic, Tungsten Carbide and Silicone Carbide.
NBR, EPDM, VITON®, Silicone, PTFE, Chloroprene, FEP and KALREZ

With conical spring / cylindrical spring, rubber seals, diaphragm seals, multi-spring, etc. In accordance with EN 12756 (DIN 24960) and ISO 3069 standards, in metric or imperial sizes.

Used in household pumps, gardens, pools, hydromassage equipment, cleaning equipment, industrial auxiliary services, etc.

DIMENSION FOR MODEL

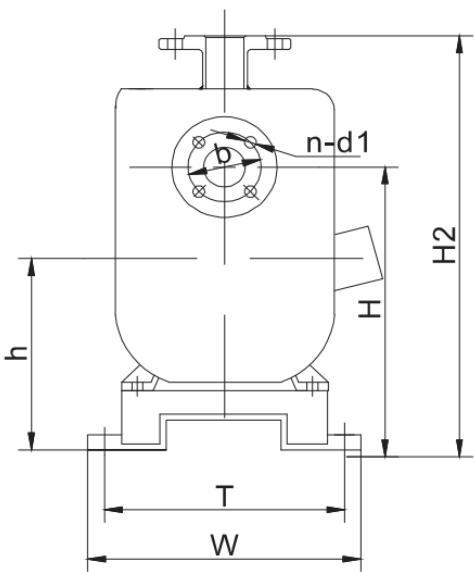
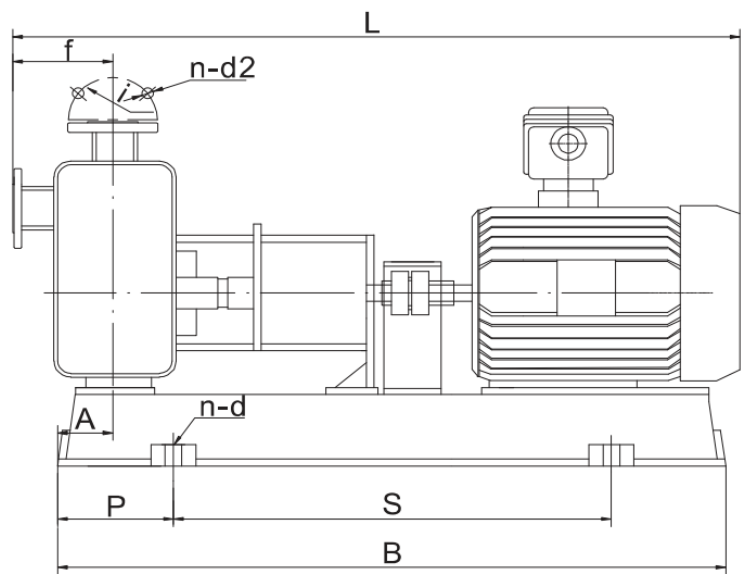
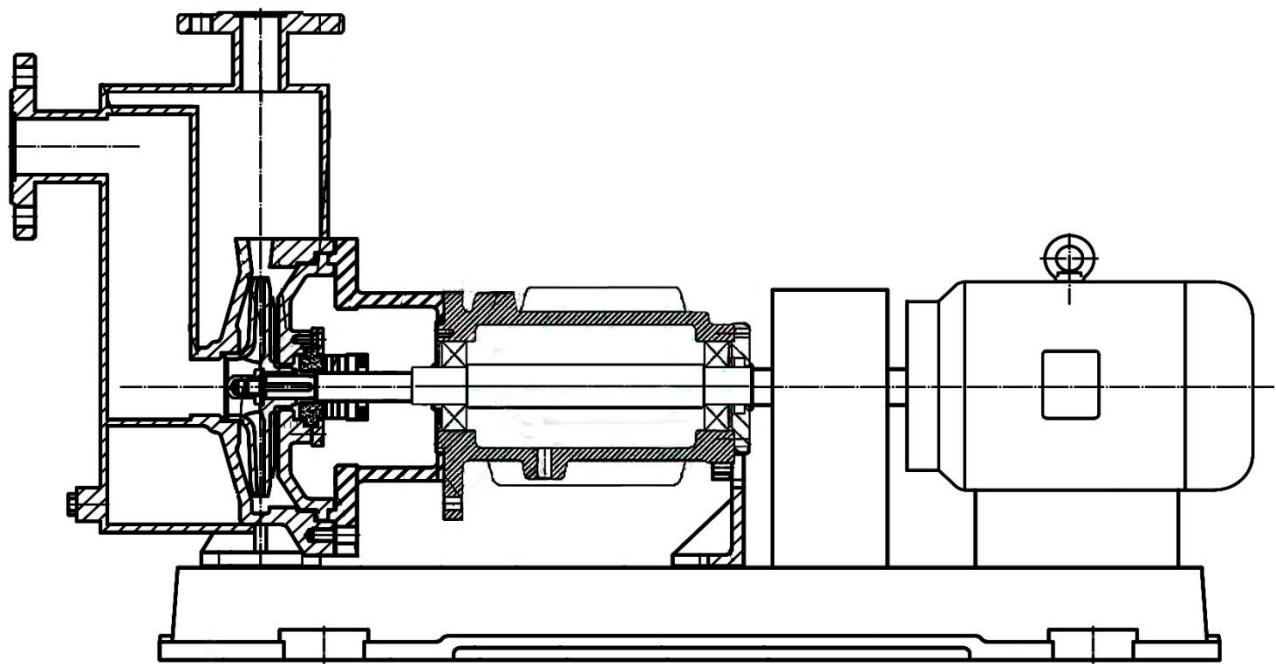

Model	Power	Mounting dimensions															
	kw	A	B	P	S	f	L	W	T	H	h	H2	b	n-d1	i	n-d2	n-d
25-20-125	1.1-2p	80	720	130	500	80	895	365	315	360	210	460	110	4-14	100	4-14	4-18
25-20-160	1.5-2p	80	720	130	500	80	895	365	315	360	210	460	110	4-14	100	4-14	4-18
25-20-200	4-2p	80	720	130	500	80	895	365	315	430	225	530	110	4-14	100	4-14	4-18
25-20-250	7.5-2p	80	720	130	500	80	895	365	315	430	225	530	110	4-14	100	4-14	4-18
32-20-125	1.5-2p	80	720	130	500	80	800	365	315	360	210	460	110	4-14	100	4-14	4-18
32-20-160	3-2p	80	720	130	500	80	800	365	315	360	210	460	110	4-14	100	4-14	4-18
32-20-200	4-2p	80	720	130	500	80	800	365	315	430	225	530	110	4-14	100	4-14	4-18
32-20-250	7.5-2p	80	720	130	500	80	800	365	315	430	225	530	110	4-14	100	4-14	4-18
40-25-125	1.5-2p	80	720	130	500	80	895	365	315	360	210	460	110	4-14	100	4-14	4-18
40-25-160	3-2p	80	720	130	500	80	895	365	315	360	210	460	110	4-14	100	4-14	4-18
40-25-200	5.5-2p	80	720	200	500	80	895	365	315	430	225	530	110	4-14	100	4-14	4-18
40-25-250	11-2p	95	900	130	550	95	1100	550	500	430	225	530	110	4-14	100	4-14	4-18
50-32-125	2.2-2p	80	760	130	500	80	950	365	315	360	210	460	110	4-14	100	4-14	4-18
50-32-160	3-2p	80	760	130	500	80	1025	365	315	360	210	460	110	4-14	100	4-14	4-18
50-32-200	7.5-2p	80	820	130	560	80	934	420	370	430	225	530	110	4-14	100	4-14	4-18
50-32-250	11-2p	95	1200	200	800	100	1355	550	500	430	225	530	110	4-14	100	4-14	4-18
65-50-125	3-2p	80	160	130	500	80	995	365	315	350	200	530	130	4-18	110	4-14	4-18
65-50-160	5.5-2p	80	820	130	560	80	1078	420	370	350	200	530	130	4-18	110	4-14	4-18
65-40-200	11-2p	80	990	200	590	100	1240	450	400	370	210	530	130	4-18	110	4-14	4-18
65-40-250	18.5-2p	80	1200	200	800	100	1395	550	500	445	235	550	130	4-18	110	4-14	4-18
65-40-315	30-2p	80	1350	225	850	125	1530	600	550	445	235	550	130	4-18	110	4-14	4-18
80-65-125	5.5-2p	80	830	130	560	100	1095	420	370	345	210	545	150	4-18	130	4-14	4-18
80-65-160	11-2p	80	990	200	590	100	1240	450	400	350	200	530	150	4-18	130	4-14	4-18
80-50-200	15-2p	80	990	200	590	100	1240	450	400	380	240	580	150	4-18	130	4-14	4-18
80-50-250	30-2p	95	1200	200	800	125	1530	550	500	420	240	580	150	4-18	130	4-14	4-18
80-50-315	37-2p	95	1270	200	870	125	1530	550	500	450	260	630	150	4-18	130	4-14	4-18
100-80-125	11-2p	95	990	200	590	100	1240	450	400	420	260	640	145	4-18	125	4-18	4-18
100-80-160	15-2p	95	990	200	590	100	1355	450	400	420	260	640	145	4-18	125	4-18	4-18
100-65-200	30-2p	95	1190	225	740	100	1545	550	500	450	280	680	145	4-18	125	4-18	4-18
100-65-250	45-2p	110	1320	250	840	125	1570	600	550	575	350	790	145	4-18	125	4-18	4-18
100-65-315	75-2p	110	1320	250	840	125	1635	600	550	575	350	790	145	4-18	125	4-18	4-18
125-100-200	55-2p	110	1720	320	1100	125	1700	700	650	420	260	640	185	4-18	145	4-18	4-18
125-100-250	75-2p	110	1320	250	840	140	1820	600	550	420	260	640	185	4-18	145	4-18	4-18
125-100-315	15-4p	110	1250	225	850	140	1560	600	550	420	260	640	185	4-18	145	4-18	4-18
125-100-400	37-4p	130	1320	250	840	140	1615	600	550	575	350	790	185	4-18	145	4-18	4-18
150-125-250	22-4p	110	1250	225	850	140	1540	600	550	500	290	790	240	4-20	185	4-20	4-20
150-125-315	45-4p	130	1320	250	840	140	1615	600	550	500	290	790	240	4-20	185	4-20	4-20
150-125-400	75-4p	110	1520	260	1000	140	1745	650	600	570	350	880	240	4-20	185	4-20	4-20