



S - T - R

## ST RESOURCES THAILAND CO., LTD

No. 9 The place Building, 2nd fl., Unit 2201, Chan Road 18/2,  
Thung Wat Don, Sathorn, Bangkok 10120

Website: <https://stresourcesthailand.com>

E- Mail: [sales@stresourcesthailand.com](mailto:sales@stresourcesthailand.com)

Sales support department (Petro equipment)

Contact: Mr. Povitha



### HORIZONTAL CENTRIFUGAL PUMP

MODEL: TNP WITH EN 733 STANDARD



## DESCRIPTION OF PRODUCT

The model TNP Series – horizontal centrifugal pumps are mechanical devices that use centrifugal force to transport fluids. They are widely used in various industries for their ability to efficiently move liquids, including water, chemicals, oil, and more. These pumps are designed with a horizontal shaft and are known for their reliability, ease of maintenance, and versatility.

This is the type of end suction, long coupled, single stage centrifugal chemical process pump is standardized to EN733 and can be used for a wide range of applications in the industrial and marine markets.

## STANDARD DESIGN

The model TNP – coupled horizontal centrifugal pump according to with DIN 24255 and EN733 international standard, this means that the pump is dimensionally the same as many other pumps on the market, this enables the replacement of most horizontal centrifugal pumps that are already installed.

## MAIN USAGE

Centrifugal pumps are widely used in various industries and applications included fuel transfer, chemical, energy plants, mining, firefighting, irrigation, water supply, water treatment, dewatering, and marine,...

## MODEL PUMP

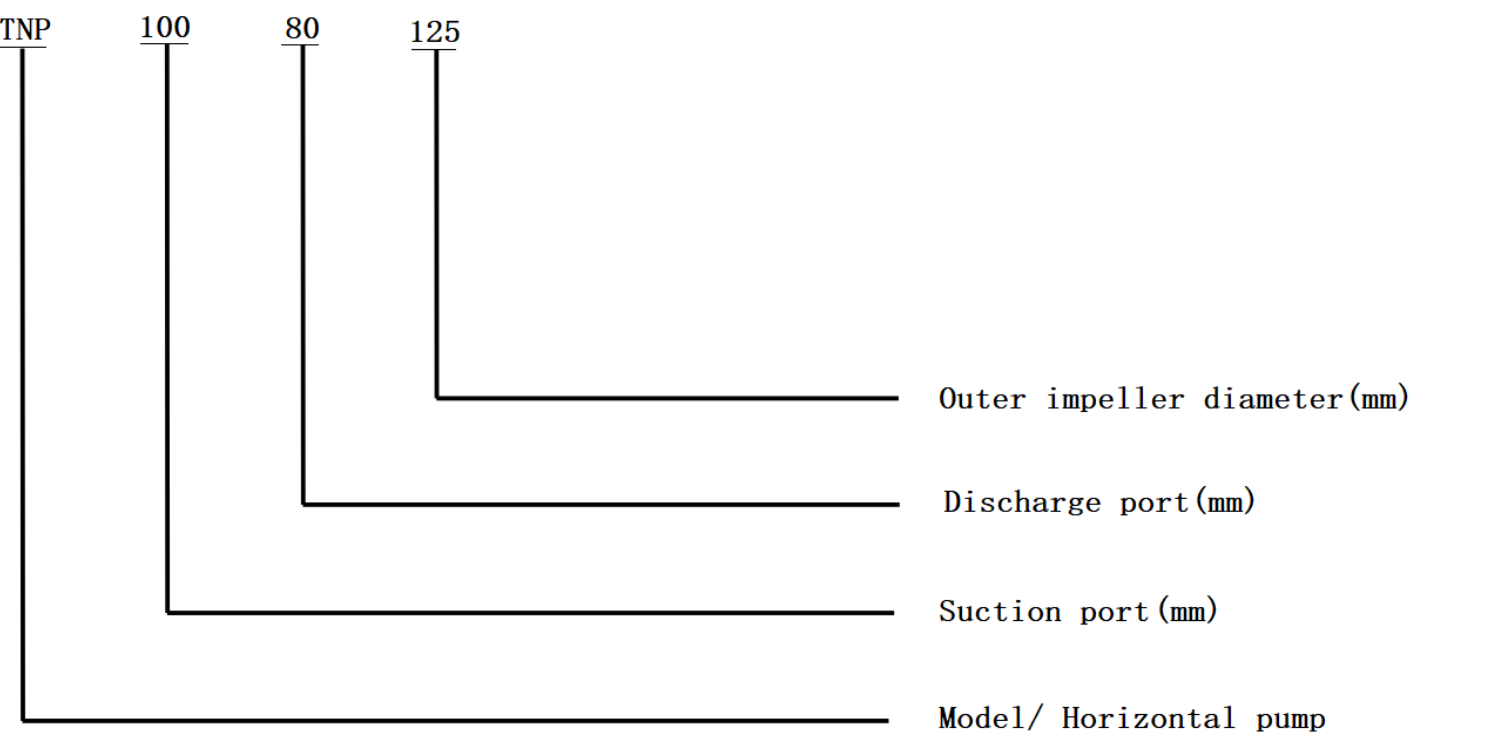

# DRAWING PUMP

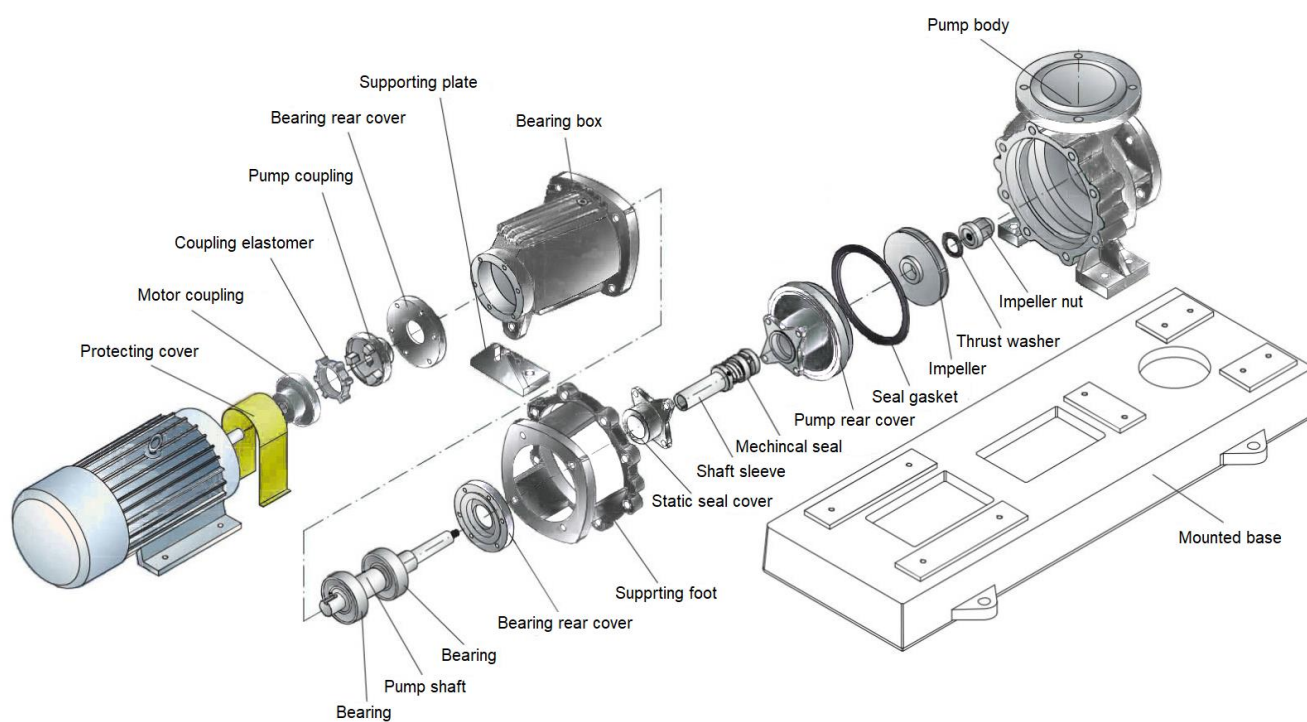
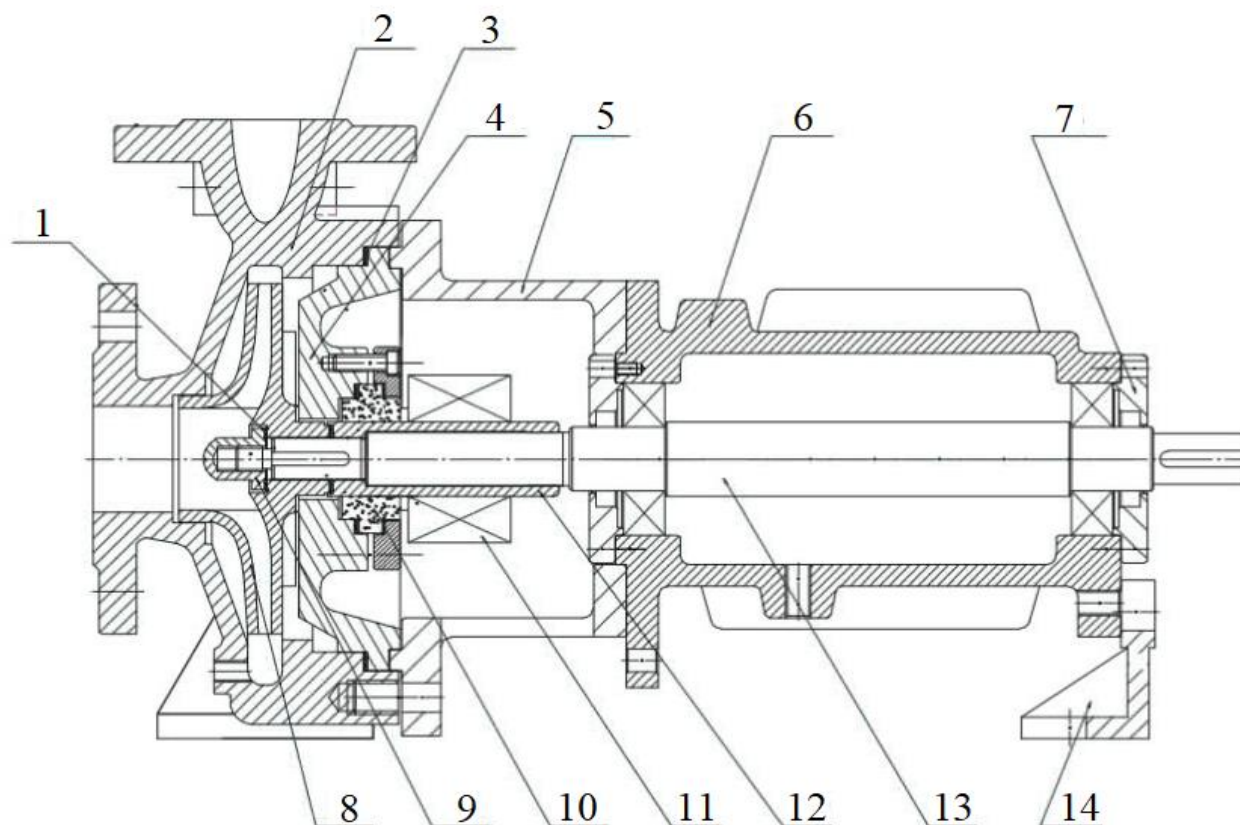



## PART NUMBER AND PART NAME

Name	No.	Material	Name	No.	Material
Thrust washer	1	PTFE/Viton	Impeller	8	Stainless steel
Pump body	2	WCB/stainless steel	Impeller nut	9	Stainless steel
Seal gasket	3	PTFE/Viton	Static seal ring	10	Sic
Pump cover	4	WCB/stainless steel	Dynamic seal ring	11	PTFE/Sic
Supporting foot	5	WCB/stainless steel	Shaft sleeve	12	Stainless steel
Bearing box	6	WCB/stainless steel	Pump shaft	13	Stainless steel
Bearing cover	7	WCB/stainless steel	Supporting plate	14	WCB/stainless teel

## PERFORMANCE CURVE

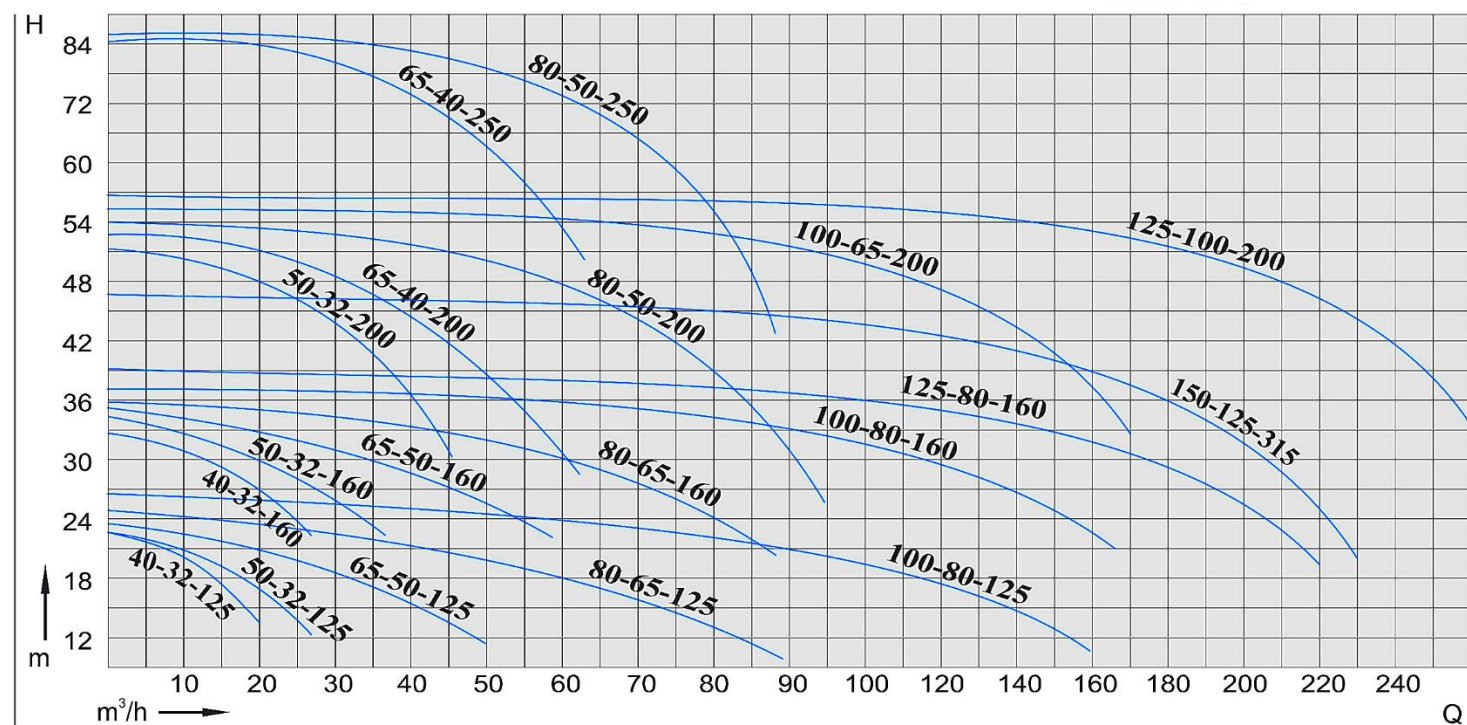

Notes: Performance curve will be provided with each offer and included the requested model for clients

## MODEL SELECTION

No.	Model	Flow	Head	EFF	NPSH	Suction	Discharge	Speed	Motor power	Weight
		m3/h	m	%						
1	25-20-125	1.5	22	28	1.8	25	20	2900	1.5	80
		*2	20	36						
		3.2	18.5	34						
2	25-20-160	1.5	34.3	24	1.8	25	20	2900	2.2	85
		*2	32	32						
		3.2	29.6	33						
3	25-20-200	1.5	52.5	28	1.8	25	20	2900	5.5	130
		*2	50	32						
		3.2	48	30						
4	25-20-250	1.5	82	26	1.8	25	20	2900	11	230
		*2	80	30						
		3.2	78.5	28						
5	32-20-125	2	22	40	1.8	32	20	2900	1.5	80
		*3.2	20	44						
		5.5	18.5	42						
6	32-20-160	2	34.3	40	1.8	32	20	2900	2.2	103
		*3.2	32	44						
		5.5	29.6	42						
7	32-20-200	2	52.5	32	1.8	32	20	2900	5.5	145
		*3.2	50	36						
		5.5	48	34						
8	32-20-250	2	82	26	1.8	32	20	2900	11	165
		*3.2	80	30						
		5.5	78.5	28						
9	40-25-125	4.4	22	41	1.8	40	25	2900	1.5	80
		*6.3	20	46						
		8.3	18.5	43						



SS impeller



SS shaft sleeve



SS shaft



Mechanical seal

No.	Model	Flow	Head	EFF	NPSH	Suction	Discharge	Speed	Motor power	Weight
		m3/h	m	%	m	mm	mm	rpm	kw	kg
10	40-25-160	4.4	34.3	35	1.8	40	25	2900	2.2	130
		*6.3	32	40						
		8.3	29.6	38						
11	40-25-200	4.4	52.5	26	1.8	40	25	2900	5.5	172
		*6.3	50	33						
		8.3	48	32						
12	40-25-250	4.4	82	24	1.8	40	25	2900	11	258
		*6.3	80	28						
		8.3	78.5	28						
13	50-32-125	7.5	22	43	2	50	32	2900	2.2	115
		*12.5	20	51						
		15	18.5	49						
14	50-32-160	7.5	34.3	33	2	50	32	2900	3	138
		*12.5	32	46						
		15	29.6	50						
15	50-32-200	7.5	52.5	28	2	50	32	2900	5.5	182
		*12.5	50	39						
		15	48	43						
16	50-32-250	7.5	82	23	2	50	32	2900	11	258
		*12.5	80	33						
		15	78.5	36.5						
17	65-50-125	15	21.8	14	2	65	50	2900	3	138
		*25	20	62						
		30	18.5	63						
18	65-50-160	15	35	44	2	65	50	2900	5.5	158
		*25	32	57						
		30	30	59						
19	65-40-200	15	53	41	2	65	40	2900	11	215
		*25	50	52						
		30	47	53.5						
20	65-40-250	15	82	34	2	65	40	2900	15	362
		*25	80	46						
		30	78	50						
21	65-40-315	30	127	28	2	65	40	2900	30	485
		*50	125	39						
		60	123	42.5						
22	80-65-125	30	22.5	53	2.3	80	65	2900	4	198
		*50	20	63						
		60	18	52						
23	80-65-160	30	36	57	2.3	80	65	2900	7.5	230
		*50	32	67						
		60	29	65						
24	80-50-200	30	53	53	2.5	80	50	2900	11	255
		*50	50	63						
		60	47	62						
25	80-50-250	30	84	44	2.5	80	50	2900	22	485
		*50	80	57						
		60	75	59						

No.	Model	Flow	Head	EFF	NPSH	Suction	Discharge	Speed	Motor power	Weight
		m3/h	m	%	m	mm	mm	rpm	kw	kg
26	80-50-315	30	128	39	2.5	80	50	2900	37	565
		*50	125	51						
		60	123	52.5						
27	100-80-125	60	24	64	4.2	100	80	2900	11	250
		*100	20	73						
		120	16.5	63						
28	100-80-160	60	36	60	4.3	100	80	2900	15	255
		*100	32	73						
		120	28	73						
29	100-65-200	60	54	63	3.9	100	65	2900	22	485
		*100	50	72						
		120	47	71						
30	100-65-250	60	87	57	3.6	100	65	2900	37	555
		*100	80	68						
		120	74.5	67						
31	100-65-315	60	133	48	3.2	100	65	2900	75	675
		*100	125	62						
		120	118	64						
32	125-80-160	120	36	65	4.5	125	80	2900	22	485
		160	32	69						
		175	28	68						
33	125-100-200	120	57.5	68	5	125	100	2900	45	665
		*200	50	77						
		240	44.5	70						
34	125-100-250	120	87	63	4.5	125	100	2900	75	855
		*200	80	75						
		240	72	74						
35	125-100-315	60	33.5	57	5	125	100	1450	15	955
		*100	32	68						
		120	30.5	67						
36	125-100-400	60	52	56	5	125	100	1450	30	1060
		*100	50	62						
		120	48.5	58						
37	150-125-250	120	22.5	66	4.5	150	125	1450	22	640
		*200	20	77						
		240	17.5	68						
38	150-125-315	120	34	63	4.5	150	125	1450	37	710
		*200	32	75						
		240	29	72						
39	150-125-400	120	53	61	4.5	150	125	1450	55	1250
		*200	50	70						
		240	46	63						
40	200-150-250	240	21.5	72	3.2	200	150	1450	45	720
		*400	20	79						
		460	17.5	75						
41	200-150-315	240	37	67	3.2	200	150	1450	75	1200
		*400	32	79						
		460	28.5	77						
42	200-150-400	240	55	67	3.2	200	150	1450	90	1450
		*400	50	78						
		460	45	75						

Note: The above are rated parameters, the actual operating parameters and rated parameters are different, it can be replace the impeller to meet the requirements.

## DIMENSION FOR MODEL

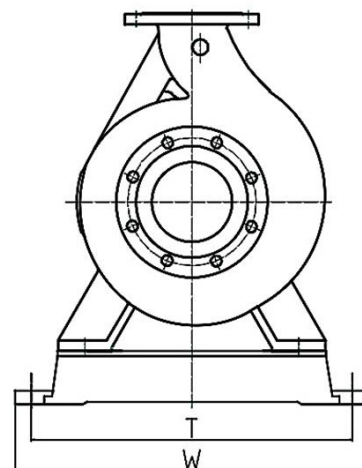
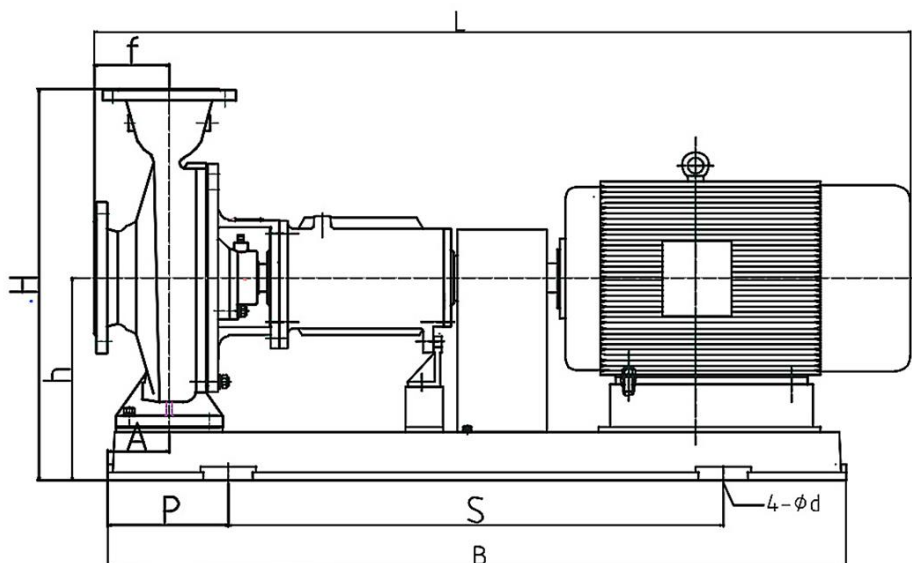

Model	L	B	S	P	A	W	T	H	h	f	4-φd
40-25-125	786	760	540	110	60	360	320	308	178	80	4- Ø20
40-25-160	806	760	540	110	60	360	320	338	198	80	4- Ø20
40-25-200	910	895	655	155	80	395	345	430	260	80	4- Ø25
50-32-125	950	895	590	155	80	395	330	352	212	80	4-Ø 19
50-32-160	1025	895	590	155	80	395	330	392	232	80	4-Ø 25
50-32-200	1075	990	650	170	80	450	380	440	260	80	4-Ø 25
65-50-125	995	895	590	155	80	395	330	352	212	80	4-Ø 25
65-50-160	1075	990	650	170	80	450	380	392	232	80	4-Ø 25
65-40-200	1180	1160	720	205	95	485	435	440	260	100	4-Ø 25
65-40-250	1350	1270	840	215	100	490	440	510	285	100	4-Ø 24
80-65-125	1095	995	655	170	80	450	400	392	232	100	4-Ø 25
80-65-160	1180	1160	720	205	95	485	435	440	260	100	4-Ø 25
80-50-200	1180	1160	720	205	95	485	435	460	260	100	4-Ø 25
80-50-250	1543	1420	940	240	95	610	550	525	300	125	4-Ø 24
100-80-125	1180	1130	720	200	95	485	435	440	260	100	4-Ø 24
100-80-160	1190	1130	720	205	95	485	435	500	280	100	4-Ø 24
100-65-200	1543	1420	940	240	95	610	540	525	300	100	4-Ø 24
125-80-160	1543	1420	940	240	95	610	540	525	300	125	4-Ø 28
125-100-200	1690	1620	1055	280	110	660	600	650	370	125	4-Ø 28

Notes: Dimension will be provided with each offer and included the requested model for clients